



# AP50

---

## Instruction manual

---



## These instructions apply to the AP50.

Due to the updating of the products, there may be differences between the illustrations and the products. Please read the information on the relevant products.

|  |           |
|--|-----------|
| <b>1. SAFETY .....</b>                       | <b>7</b>  |
| 1.1 Intended use .....                       | 7         |
| 1.2 Incorrect use.....                       | 7         |
| 1.3 Danger list.....                         | 8         |
| 1.4 Residual risks.....                      | 10        |
| 1.5 Personal protective equipment.....       | 10        |
| <br>   |           |
| <b>2. GENERAL INFORMATION.....</b>           | <b>11</b> |
| 2.1 Information about the sales partner..... | 11        |
| 2.2 Information about the manufacturer ..... | 12        |
| 2.3 Information about the machine.....       | 13        |
| 2.4 Guarantee.....                           | 14        |
| 2.5 Symbols used in this instruction.....    | 14        |
| 2.6 Qualification of staff.....              | 15        |
| <br>   |           |
| <b>3. MACHINE DESCRIPTION.....</b>           | <b>17</b> |
| 3.1 Machine description .....                | 18        |
| 3.2 Technical data .....                     | 20        |
| 3.2.1 Noise emission .....                   | 21        |
| 3.3 Machine dimensions .....                 | 21        |
| <br>   |           |
| <b>4. INSTALLATION .....</b>                 | <b>23</b> |
| 4.1 Checking and unpacking .....             | 23        |
| 4.2 Mounting the support.....                | 24        |
| 4.3 Installation location.....               | 25        |
| 4.4 Location requirements.....               | 25        |
| 4.5 Electrical requirements .....            | 26        |
| 4.6 Connections.....                         | 27        |
| 4.6.1 Connection to the water pipe .....     | 27        |
| 4.6.2 Filling the water bath.....            | 28        |

|           |  |           |
|-----------|--|-----------|
| 4.6.3     | Water connection .....                           | 29        |
| 4.6.4     | Emptying the water bath .....                    | 29        |
| 4.6.5     | Electrical connection .....                      | 30        |
| 4.6.6     | Connecting the CO <sub>2</sub> cylinder .....    | 31        |
| 4.6.7     | Changing the CO <sub>2</sub> cylinder .....      | 32        |
| 4.6.8     | Waste water connection .....                     | 32        |
| 4.7       | Initial commissioning .....                      | 33        |
| 4.7.1     | Setting up the sparkling water .....             | 33        |
| <b>5.</b> | <b>USE OF THE MACHINE .....</b>                  | <b>34</b> |
| 5.1       | Commissioning .....                              | 34        |
| 5.2       | Selection buttons .....                          | 34        |
| 5.2.1     | How to use the machine .....                     | 35        |
| 5.2.2     | Overview of the electronic functions .....       | 36        |
| 5.3       | Installation .....                               | 37        |
| 5.3.1     | Instructions for preparing sparkling water ..... | 37        |
| 5.4       | Turning off the machine .....                    | 38        |
| <b>6.</b> | <b>MAINTENANCE .....</b>                         | <b>39</b> |
| 6.1       | Maintenance .....                                | 40        |
| 6.1.1     | Cleaning and maintenance schedule .....          | 41        |
| 6.1.2     | Cleaning the housing .....                       | 41        |
| 6.1.3     | Replacing the CO <sub>2</sub> cylinders .....    | 42        |
| 6.1.4     | Cleaning the aerator .....                       | 42        |
| 6.1.5     | Cleaning the cooling condenser .....             | 42        |
| 6.1.6     | Checking the water connection .....              | 43        |
| 6.1.7     | Changing the water in the water bath .....       | 43        |
| 6.1.8     | Cleaning the drip tray .....                     | 43        |
| 6.1.9     | Power cable .....                                | 43        |
| 6.1.10    | Degassing .....                                  | 44        |
| 6.1.11    | Sanitation .....                                 | 45        |
| 6.1.12    | Testing the carbon pump .....                    | 46        |
| 6.2       | Unscheduled maintenance .....                    | 46        |

|   |           |
|---|-----------|
| <b>7. ERROR CORRECTION.....</b>             | <b>47</b> |
| 7.1 Error messages.....                     | 49        |
| 7.2 Advanced programming.....               | 50        |
| <br>  |           |
| <b>8. FURTHER INSTRUCTIONS.....</b>         | <b>54</b> |
| 8.1 Disposal.....                           | 54        |
| 8.2 Uninstallation.....                     | 54        |
| 8.3 Disposal of electronic components ..... |           |
| (WEEE-Directive).....                       | 55        |



# 1. SAFETY

The machine must not be operated by persons without appropriate instruction.

The operating condition of the machine must be maintained and no changes may be made without the manufacturer's authorisation.



## NOTE

**Please read this section of the manual carefully before commissioning the machine, as it contains information and details on both correct and incorrect use, which can cause hazards.**

---

## 1.1 INTENDED USE

This water dispenser is designed for dispensing large quantities of cold, still and carbonated water.

The machine is easy to use and made of high quality material to provide maximum hygiene and easy maintenance.

This machine is designed for domestic use and for similar applications such as:

- Staff kitchens in shops, offices and other working environments
- Country houses and hotel customers, motels and other residential facilities
- Bed & Breakfast and guesthouses
- Catering and use in similar retail

## 1.2 INCORRECT USE

This machine has been designed and built for the use and conditions described in these operating instructions and complies with the requirements of the directives listed in the declaration of conformity.

It is strictly forbidden to use the water dispenser for purposes other than its intended use. The water dispenser must be used in accordance with the instructions contained in these operating instructions.

Children under the age of 8 and adults with limited physical abilities or impaired perception may use the machine under supervision after they have been instructed in the safe use of the machine and have understood the associated dangers. Children must not play with the machine. Cleaning and maintenance, for which the user is responsible, must not be carried out unsupervised by children.

For safety reasons and in accordance with the applicable regulations, the machine may only be repaired by the customer service department.

- It is forbidden to manipulate or tamper with the components of the water dispenser. The customer service department must be contacted in the event of malfunctions
- Do not place any objects on the water dispenser
- Do not place the water dispenser on top of other objects
- Only the specified liquids may be used
- If defects occur in the water dispenser, the customer service department must be contacted
- Do not set up the machine near flammable liquids such as alcohol or solvents
- Do not install the machine in a particularly damp or dusty environment, in direct sunlight, outdoors or near heat sources, as this could cause a fire or electric shock
- The machine must not be used outdoors
- Never insert or remove the machine's mains cable from the socket with wet hands
- The machine must not be installed where water splashes may occur
- Caution! If the installation kit and connections are damaged, they must be replaced by the distributor's customer service department or persons with comparable qualifications in order to avoid any hazards
- Observe the recommended minimum distances and do not cover the ventilation grilles of the machine

### 1.3 DANGER LIST

The following list of hazards draws attention to safety aspects that must be considered by the machine operator.



**DANGER**

#### **CO<sub>2</sub> (CARBON DIOXIDE)**

**The room in which the CO<sub>2</sub> cylinders are stored must always be well ventilated and have an entrance and an exit to ensure air circulation. The release of CO<sub>2</sub> must be strictly avoided in the entire system, including the cylinders. If a CO<sub>2</sub>-release is suspected, especially in small areas, the affected area must be ventilated immediately. Persons exposed to high concentrations of CO<sub>2</sub> will exhibit tremors followed by rapid unconsciousness and asphyxiation.**

**DANGER****POWER SUPPLY**

Disconnect the power supply before carrying out any work on the machine in order to avoid damage to health and hazards.

---

**DANGER****USE OF THE CO<sub>2</sub> CYLINDER**

To avoid danger or damage, the CO<sub>2</sub> cylinder must always be placed upright against the wall and secured with a bracket and chain. Protect the CO<sub>2</sub> cylinder from heat sources and excessively low temperatures.

---

**WARNING****AUTHORISED SPECIALISTS**

Work on the machine may only be carried out by authorised specialist personnel. All cables must comply with national and local regulations (only use manufacturer-certified original spare parts when replacing parts).

---

**ATTENTION****ELECTRICAL REQUIREMENTS**

The circuit must be correctly earthed and connected via a suitable circuit breaker.

---

**ATTENTION****SANITATION**

Before disinfecting, read the manufacturer's instructions for the disinfectant carefully and wear personal protective equipment (gloves, face mask, etc.). Ensure adequate ventilation of the rooms. Disinfection work may only be carried out by specialised technical service personnel.

---

**ATTENTION****AMBIENT TEMPERATURES**

If the machine is exposed to temperatures below 0°C, the water it contains may freeze and damage the machine.

---

**ATTENTION****LIQUID CHECK VALVE**

The non-return valve of the liquid from the water dispenser must be checked after any interruption to the water supply (work on the water pipes, earthquakes, etc.) and once a year under normal conditions. If particles remain in the non-return valve, the CO<sub>2</sub> could flow back into the water pipe.

---

**ATTENTION****REFRIGERANT**

To prevent the formation of flammable gas-air mixtures in the event of a leak in the cooling circuit, the required room size in which the machine may be installed depends on the quantity of refrigerant used. The machine must not be switched on if there are signs of damage. If in doubt, contact the manufacturer. The room must have a size of 1 m<sup>3</sup> or more per 8 g of R290 refrigerant. The amount of refrigerant contained in the machine is specified on the rating plate.

## 1.4 RESIDUAL RISKS

The machine is safe under the intended operating conditions. However, there are residual risks which are listed in the hazard list and which can be minimised if the machine is used correctly and the instructions contained in the user and maintenance manual are observed.

## 1.5 PERSONAL PROTECTIVE EQUIPMENT (PSA)



**DANGER**

**Personal protective equipment (PSA) must comply with the regulations specified in the safety data sheet for the products handled.**

The following personal protective equipment must be used when carrying out special maintenance work or when handling potentially hazardous liquids or gases:



Use hand protection.



Use breathing protection.



Use eye protection.

## 2. GENERAL INFORMATION

The operating and maintenance instructions must be regarded as an integral and essential part of the machine and must be handed over to the user.

The manual must be kept and read carefully as it contains information on the operation, maintenance and safety of the machine, persons and/or objects that come into contact with it. If you have any questions or are unclear about the information in the manual, please contact your sales partner.

The manufacturer accepts no contractual or non-contractual liability for damage resulting from errors in the operation and installation of the machine or from failure to observe the manufacturer's instructions.



### NOTE

**The manufacturer reserves the right to modify the product and the associated technical documentation without incurring any obligation towards third parties and shall not be liable for any errors or inaccuracies in the content of this manual.**

**This version of the operating and maintenance instructions describes the characteristics of the standard machine at the time this publication was authorised for printing.**

---

### 2.1 INFORMATION ABOUT THE SALES PARTNER

#### **coffee perfect GmbH**

Netter Platz 1  
49090 Osnabrück - Germany

Tel. +49 (0) 541 76013 - 0

Fax: +49 (0) 541 76013 - 499

[info@coffee-perfect.de](mailto:info@coffee-perfect.de)

[www.coffee-perfect.de](http://www.coffee-perfect.de)

If you have technical problems or need to order spare parts, please contact coffee perfect.

## 2.2 INFORMATION ABOUT THE MANUFACTURER

**CELLI S.p.A.**

Via Casino Albini, 605 47842 San Giovanni in Marignano – (RN) – Italy

Tel.+39 0541 755211 Fax +39 0541 759735 – +39 0541 759838

It is recommended that original spare parts are used to replace parts of the machine; if non-original parts are used, the manufacturer / sales partner is not liable for any impairment of machine performance or damage to the machine.

## 2.3 INFORMATION ABOUT THE MACHINE

This manual refers to the following machine:

→ **AP50**

Ensure that the machine supplied has the following type plate (CE plate).

- 1) Name of the manufacturer
- 2) Machine model
- 3) CE
- 4) Rated power
- 5) Climate class
- 6) Type and weight of refrigerant gas
- 7) Supply voltage
- 8) Frequency
- 9) Serial number
- 10) Year of construction- Month

1

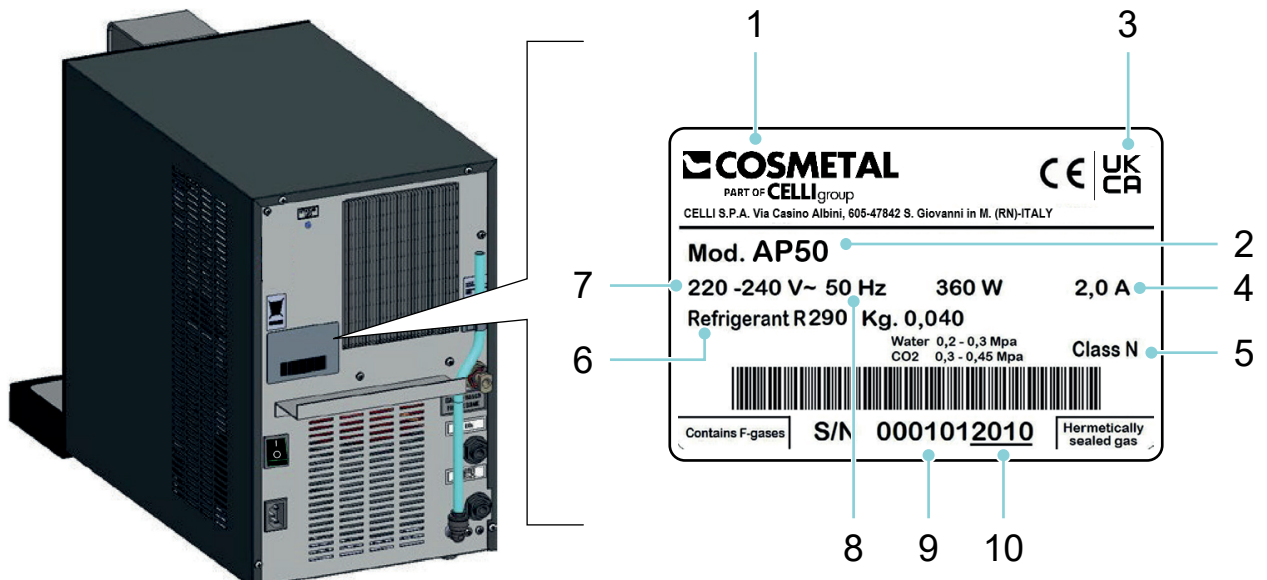

It lists the model, serial number and all technical data of the machine required for ordering spare parts or reporting technical problems to the customer service department.

## 2.4 GUARANTEE

Please refer to the general terms and conditions of sale for the warranty conditions.

## 2.5 SYMBOLS USED IN THIS INSTRUCTIONS

This manual uses the following safety symbols to indicate procedures that must be strictly observed by the operator to ensure the safety of the machine and persons.



**DANGER**

Indicates that there is an actual hazardous situation on the machine or in its vicinity for the operator and for persons in general that could lead to death or serious injury; the utmost attention and extreme caution are required.



**WARNING**

Indicates that there is a potentially hazardous situation on or near the machine that could result in death or serious injury to the operator and persons in general; extreme attention and extreme caution are required.



**ATTENTION**

Indicates that there is a potentially hazardous situation on or near the machine for the operator and for persons in general, which may cause minor but not serious injuries; maximum attention and extreme caution are required.

---

## 2.6 QUALIFICATION OF STAFF

To ensure that all work performed on the machine is carried out under safe conditions, it is necessary that the personnel responsible have the qualifications and requirements to carry out these operations.

The staff is organised as follows:



### **Specialised service technician**

Qualified personnel to carry out complex operations in exceptional situations. These are personnel who have been sufficiently trained through specific activities.



### **Operating personnel of the machine**

Unqualified personnel, i.e. without specialised skills, only able to carry out simple operations, i.e. operating the machine using the control buttons provided on it and carrying out simple cleaning and product replacement operations, following the instructions given in this manual while operating the machine. Must not carry out interventions reserved for specialised service technicians.



**NOTE**

**The pictogram at the beginning of each paragraph indicates the personnel authorised to carry out the operations described.**

---



### 3. MACHINE DESCRIPTION

This water dispenser has been designed to dispense large quantities of chilled water (still or sparkling).

The machine is easy to use and is made of high quality materials to ensure maximum hygiene and easy maintenance.

The machine must be connected to a drinking water pipe and can be fitted with a special filter set. The machine is suitable for installation in various environments, such as bars, restaurants, offices and private homes.

The machine must be installed in a closed room in which the ambient conditions described in the section on page 18 are guaranteed. The machine has an in-built cooling system that cools the water to a temperature of 3-10 °C.

The water is cooled by direct cooling. The water is cooled with a direct cooling system (ice bank). The machine is equipped with a disinfection system with UV lamp for the water.

---

2

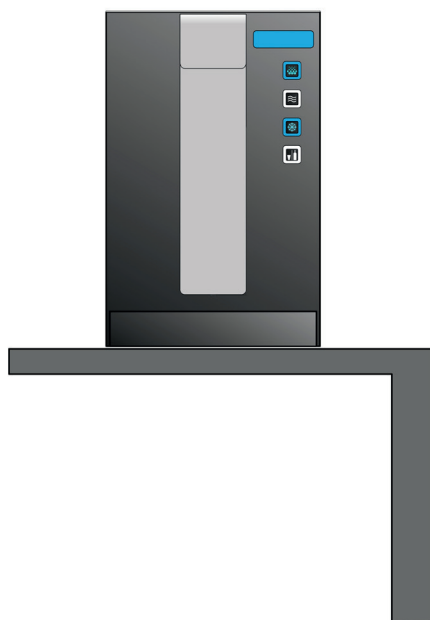



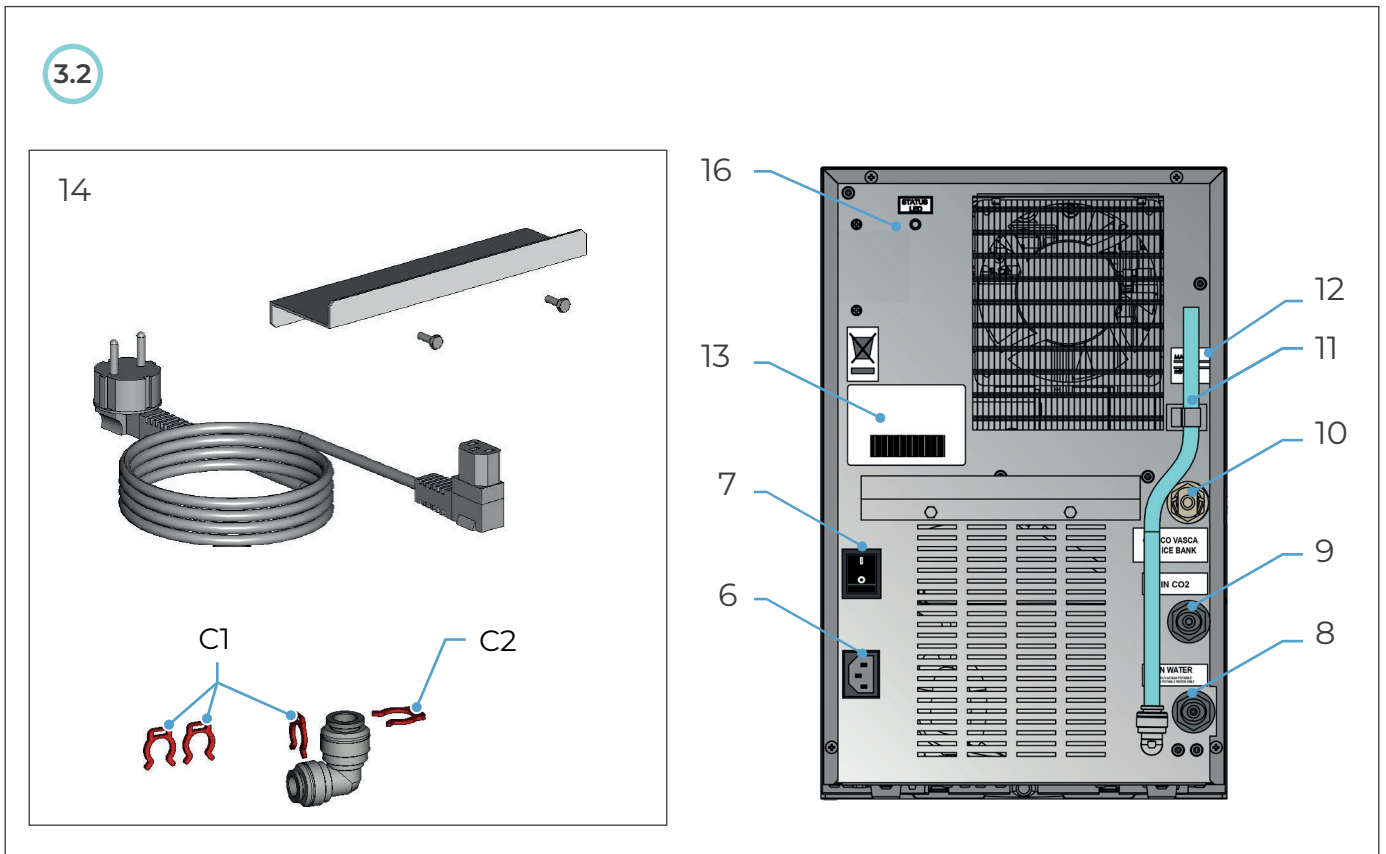
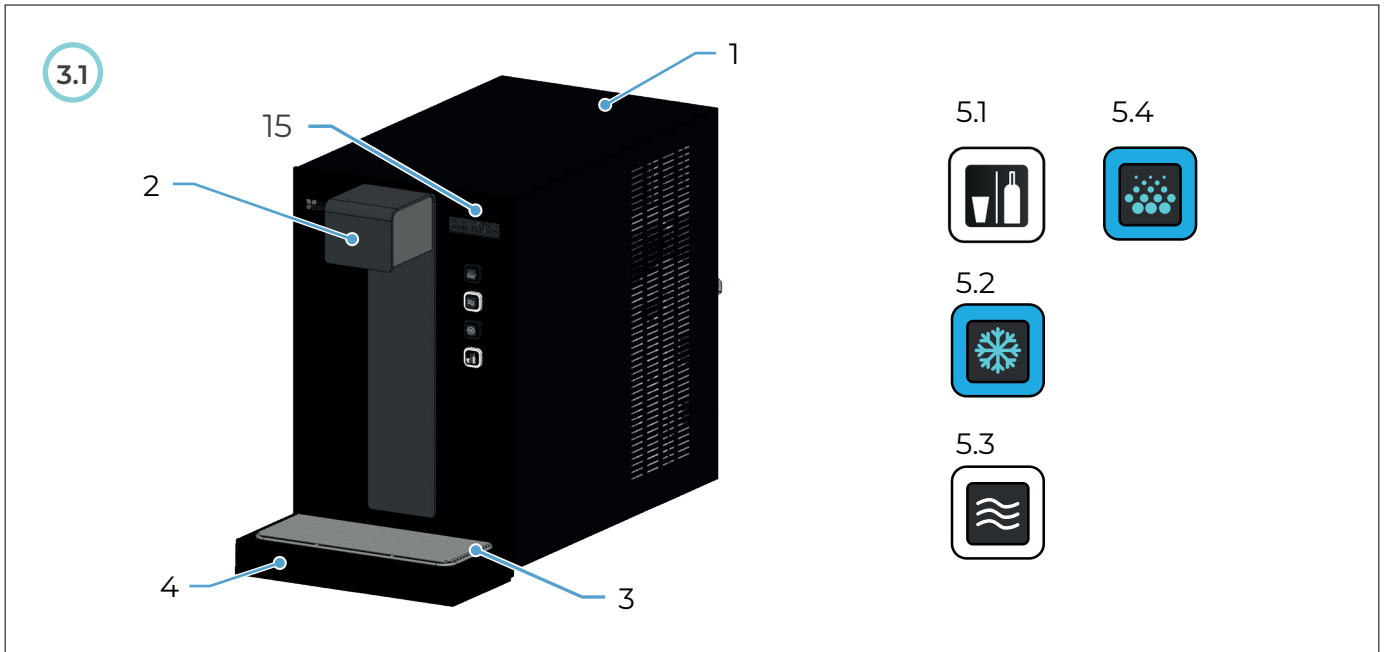

### 3.1 MACHINE DESCRIPTION



- 1) Housing
- 2) Output area: protected housing
- 3) Drip tray grid
- 4) Drip tray for draining water
- 5.1) Button for setting the dispensing quantity - Settings menu
- 5.2) Dispensing cold water
- 5.3) Output ambient water
- 5.4) CO<sub>2</sub> water output
- 6) Power socket
- 7) On and off switch
- 8) Water connection
- 9) CO<sub>2</sub> connection
- 10) Water connection for filling the water bath
- 11) Water bath drain hose
- 12) Water level display
- 13) Type plate
- 14) Installation kit
- 15) Display
- 16) LED UV Status

## 3.2 TECHNICAL DATA

|  |              | AP50  |
|--|--------------|---|
| Drinking water production  | Lt/h<br>usg  | 30<br>7,92  |
| Output temperature   | °C<br>°F     | 3 - 10<br>37,4 - 50   |
| Ongoing cold water supply  | Lt<br>usg    | 7<br>1.8  |
| Cooling system   |              | Ice bank  |
| Compressor   | HP           | 1/12  |
| Total power consumption  | Watt         | 360   |
| Pump flow rate   | l/h<br>usg/h | 100<br>26,4   |
| Power supply   | Volt/Hz      | 220 - 240 / 1 / 50 Hz<br>All special voltages are indicated on the 'Serial number' plate. |
| Net weight   | kg<br>lbs    | 28<br>61,7  |
|  Still water (ambient)                            |              | ✓   |
|  Still water (cooled)                             |              | ✓   |
|  Sparkling water (with CO <sub>2</sub> , chilled) |              | ✓   |
|  Dispensing quantity (glass / carafe)             |              | ✓   |
| Filling quantity - g   | R290         | 40  |
| Noise emission   | dB           | < 70  |

### 3.2.1 NOISE EMISSION

The machine was designed and manufactured to minimise noise at source.

The weighted sound pressure level 'A' is below 70 dB (A).

### 3.3 MACHINE DIMENSIONS

4

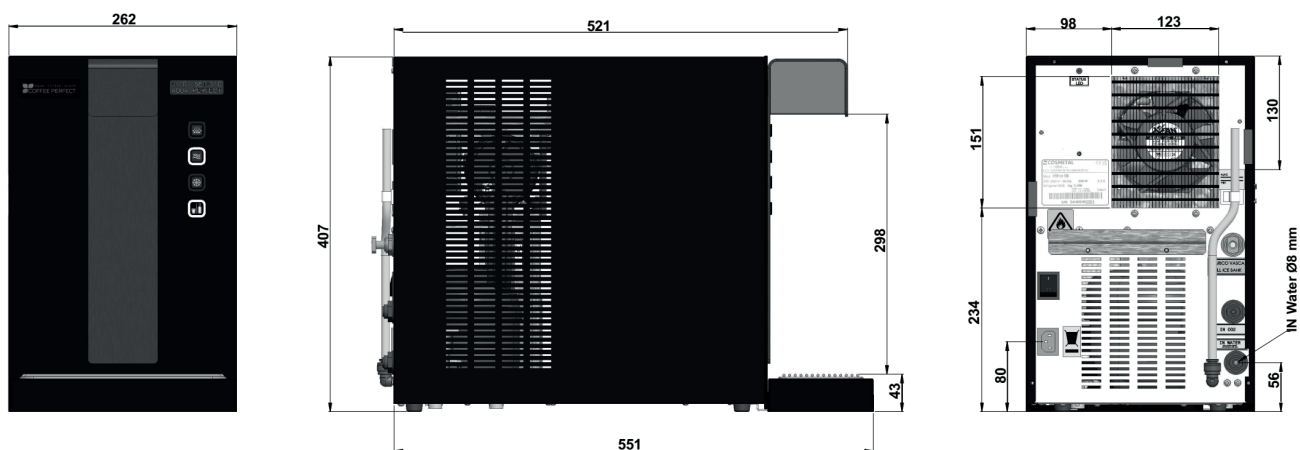



## 4. INSTALLATION

### 4.1 CHECKING AND UNPACKING



Always check that the delivered machine corresponds to the delivery note. The machine is delivered in cardboard packaging.

If the packaging is damaged, check in the presence of the carrier whether the machine has been damaged. Report any damage to the carrier.

The manufacturer or sales partner is not liable for transport damage. We recommend contacting the sales partner for components or original spare parts.



#### NOTE

The machine is packed in cardboard packaging and in sufficient shock-absorbing material. Dispose of the packaging in accordance with local regulations. Do not incinerate packaging materials and dispose of them in an environmentally friendly manner.



#### ATTENTION

During handling, the dispensing area must never be used to lift the machine. The machine must be lifted by the housing and carried by at least two people.

5

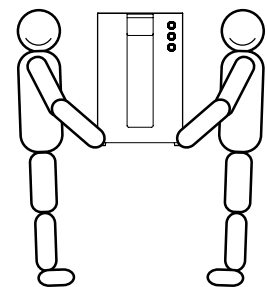
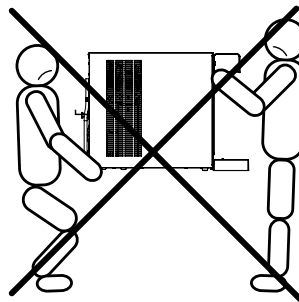
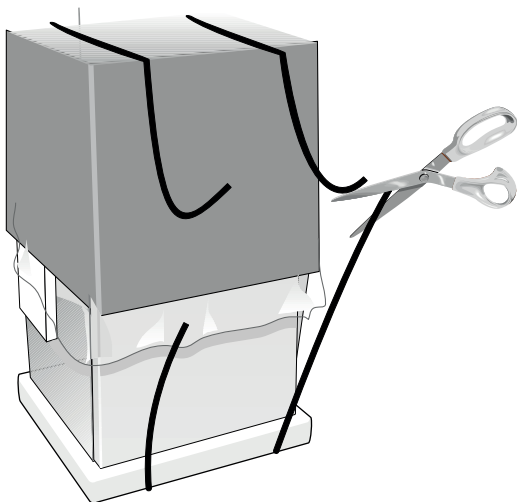



## 4.2 MOUNTING THE SUPPORT

Once the packaging has been removed, the spacer (A) (supplied) must be attached to the rear of the machine using the two screws (B). Tighten the screws (Fig. 6).

6

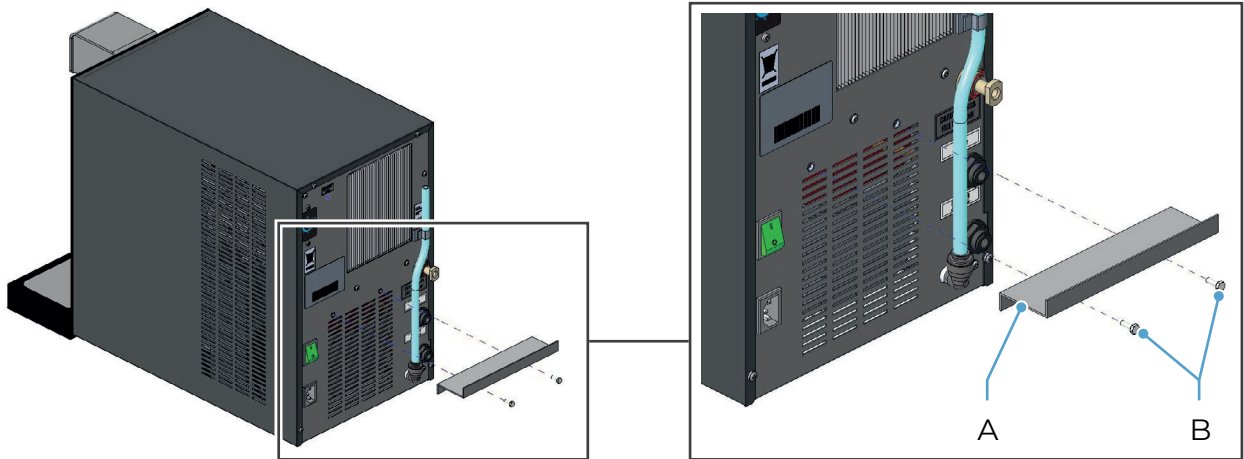



### 4.3 INSTALLATION LOCATION

Set up your machine at the desired installation location. Ensure that there are no heat sources in the immediate vicinity and that the machine is not exposed to direct sunlight.

The machine is not suitable for outdoor use and installation in very humid environments is not recommended.

- A free space (A) of approx. 50 - 60 mm should be maintained around the machine for ventilation (Fig. 7)

7

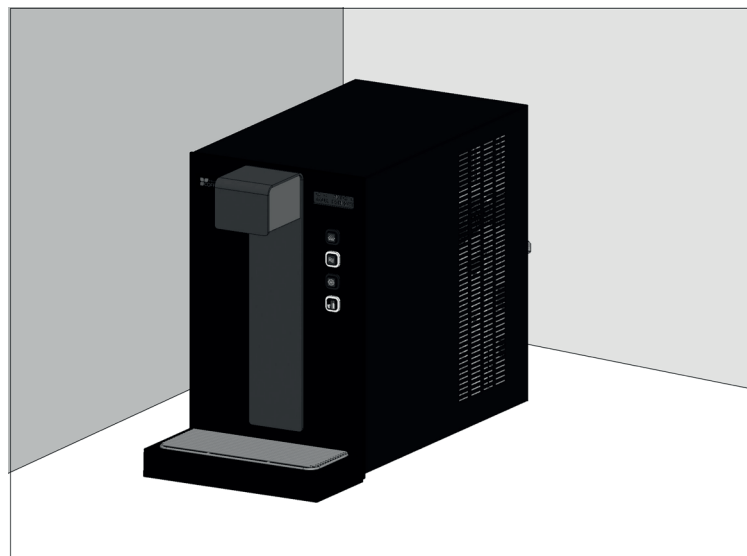

### 4.4 LOCATION REQUIREMENTS

The location of the machine must be protected from rain and water splashes and must have a temperature that corresponds to the climate class specified on the CE plate, otherwise the factory warranty will be invalidated and faults may occur.

The following climate classes are possible:

- SN - For ambient temperatures between 10 °C and 32 °C
- N - For ambient temperatures between 16 °C and 32 °C
- ST - For ambient temperatures between 18 °C and 38 °C
- T - For ambient temperatures between 18 °C and 43 °C



**ATTENTION**

#### **AMBIENT TEMPERATURES**

**If the machine is exposed to temperatures below 0°C, the water it contains may freeze and damage the machine.**



## 4.5 ELECTRICAL REQUIREMENTS



### NOTE

Ensure that the electrical requirements correspond to the specifications on the rating plate of the machine.



### DANGER

#### ELECTRICITY GRID

Disconnect the power supply before carrying out any work on the machine in order to avoid damage to health and hazards.



### ATTENTION

#### ELECTRICAL REQUIREMENTS

The circuit must be correctly earthed and connected via a suitable circuit breaker.



### ATTENTION

#### SUPPLIED PLUG

Connect the machine to the mains using the plug supplied. If the plug needs to be replaced, use an equivalent model approved in the country of use.

Do not connect the machine to a plug contact to which other devices are connected (extensions, 2 or 3 connection adapters, etc.).

Do not use the machine if the power cable is tied or knotted. If the power cable is damaged, it must be replaced by the distributor's / dealer's technical service centre in order to avoid danger.



## 4.6 CONNECTIONS

The connection to the water pipe must be made with the machine switched off and the mains cable disconnected.

### 4.6.1 CONNECTION TO THE WATER PIPE

Before connecting to the water pipe, make sure that the pipe pressure is between 2 and 3 bar.

- If the line pressure is below 2 bar or the flow rate is below 2 l/min, the line pressure must be increased using an appropriate device (water pressure regulator)



NOTE

**The correct pressure is particularly important for machines equipped with a carbon dioxide enrichment device.**

Connect the water pipe (T) to the stopcock (R). (Fig. 8).  
MATERIALS NOT SUPPLIED



NOTE

**When connecting the machine to the water network, all existing pipes, seals and connections between the machine and the water connection must be replaced with new material to prevent contamination.**

8

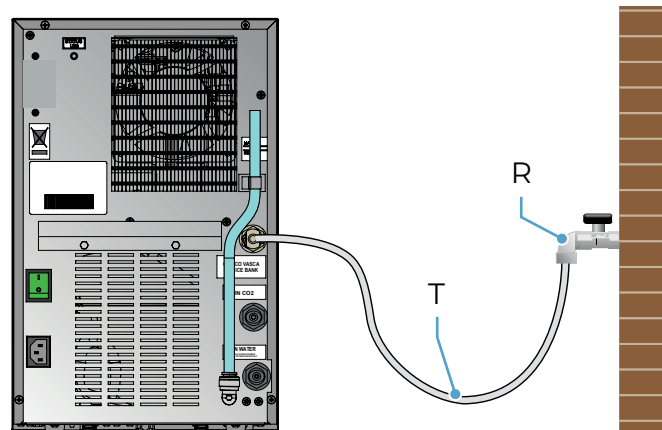

## 4.6.2 FILLING THE WATER BATH



Insert the water pipe (T) with the required pressure into the connector labelled FILL ICE BANK (Fig. 9.1).

Open the tap (R) and slowly pour water into the water bath until the water in the vertical, transparent tube (P) has reached the point indicated by the 'Fill' sign (Fig. 9.1).

Close the water tap (R) (Fig. 9.1).

9.1

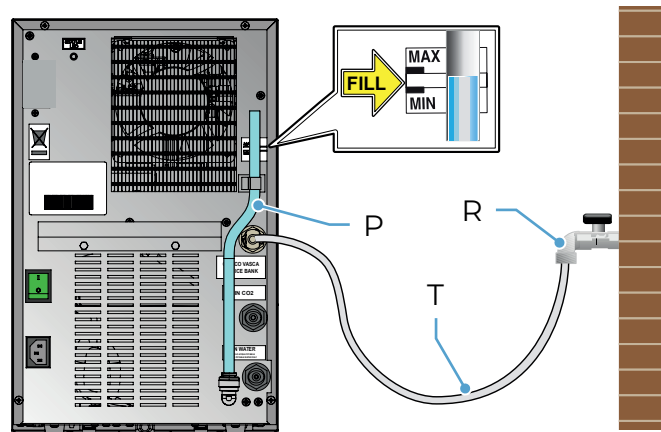

Remove the tube by pressing an 8 mm spanner onto the blocking ring and pulling off the tube at the same time (Fig. 9.2).

Then insert the red sealing plug (J) into the FILL ICE BANK connector with the necessary pressure (Fig. 9.3).

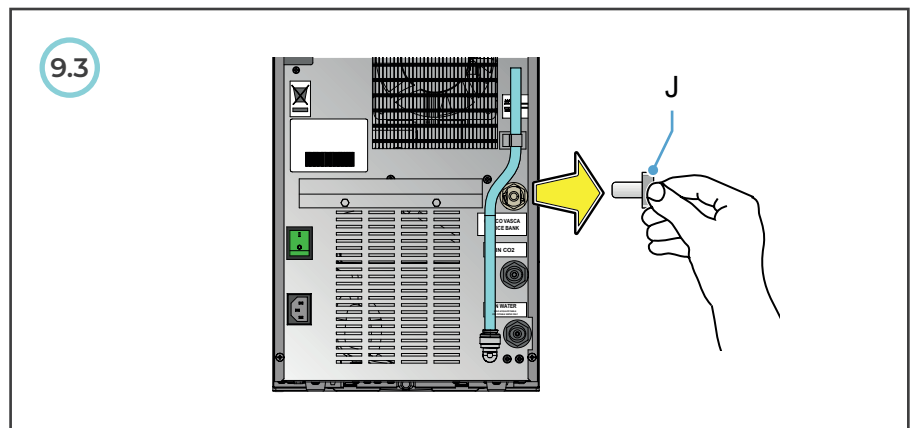



### 4.6.3 WATER CONNECTION

Assemble the elements (T), (T1), (E) and IN WATER (Fig. 10).

10

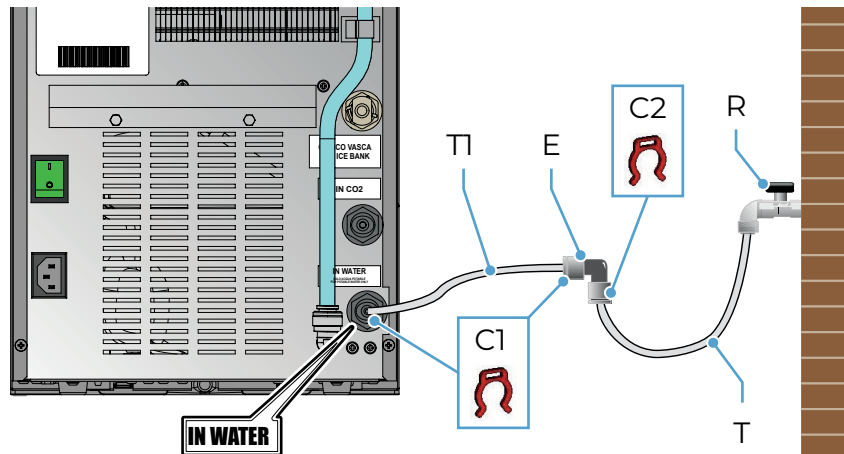

### 4.6.4 EMPTYING THE WATER BATH



- Switch off the machine at the mains switch
- Once the ice has defrosted, it is sufficient to remove the vertical hose for the water level indicator from the holder and the plug (P) and allow the water to drain off (Fig. 11)
- After emptying the water bath (approx. 4 litres), return the pipe to its vertical position

11

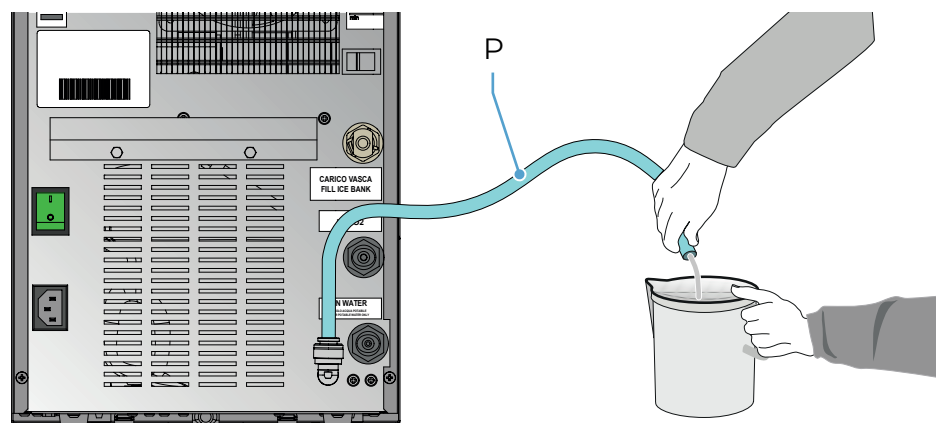



## 4.6.5 ELECTRICAL CONNECTION



ATTENTION

The intended socket outlet must be provided with a powerful earthing that corresponds to the load of the machine (see technical characteristics).



ATTENTION

Ensure that an all-pole switch with a minimum contact width of 3 mm has been installed above the socket, which must be protected by a fuse with a wattage corresponding to the absorption of the machine (see Technical characteristics).

The machine is connected to the mains by inserting the plug into a socket. Ensure that the mains voltage corresponds to the value specified on the rating plate.

Connect the machine to a mains supply with a differential circuit breaker with a tripping sensitivity of max. 30mA.

12

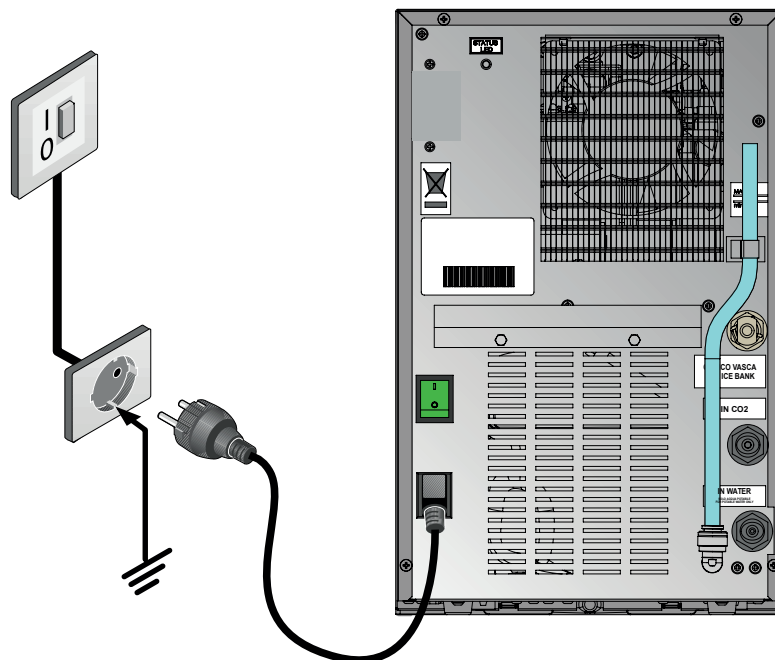

The machine fulfils the applicable safety regulations and has CE marking.

4.6.6 CONNECTING THE CO<sub>2</sub> CYLINDERCO<sub>2</sub> (CARBON DIOXIDE)

DANGER

The room in which the CO<sub>2</sub> cylinders are stored must always be well ventilated and have an entrance and an exit to ensure air circulation. The release of CO<sub>2</sub> must be strictly avoided in the entire system, including the cylinders. If a CO<sub>2</sub> release is suspected, especially in small areas, the affected area must be ventilated immediately. Persons exposed to high concentrations of CO<sub>2</sub> will exhibit tremors followed by rapid unconsciousness and asphyxiation.



DANGER

INSTALLATION OF THE CO<sub>2</sub> CYLINDER

To avoid danger or damage, the CO<sub>2</sub> cylinder must always be placed upright against the wall and secured with a bracket and chain. Protect the CO<sub>2</sub> cylinder from heat sources and excessively low temperatures. The connection hose of the gas cylinder must not run in front of the heat dissipation point.

- The CO<sub>2</sub> cylinder is mounted on the outside of the machine
- Connect the CO<sub>2</sub> fitting (R) to the connection (10)

13

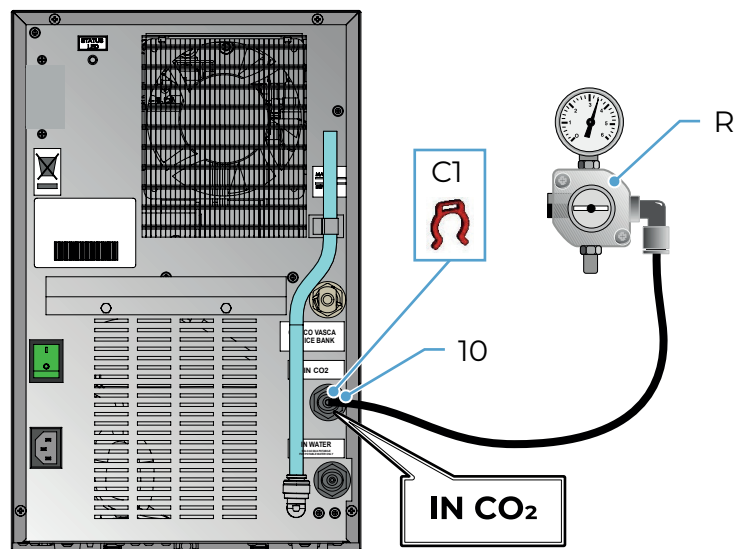



#### 4.6.7 CHANGING THE CO<sub>2</sub> BOTTLE



##### ATTENTION

**For an uncomplicated supply, we recommend the CO<sub>2</sub> delivery subscription from 'coffee perfect'. Please ensure that only CO<sub>2</sub> gas (carbon dioxide) for food is refilled.**

When using REFILLABLE gas cylinders (B-RIC), please observe the following instructions:

- Use a ring spanner to tighten the pressure regulator on the gas cylinder connection
- Open the valve on the gas cylinder

The pressure regulator is already set to an optimum gas flow (approx. 3.5 bar). One refillable gas cylinder of CO<sub>2</sub> is sufficient for approx. 140 litres of water.



#### 4.6.8 WASTE WATER CONNECTION

The machine has a drip tray that can be connected to the drain hose.



## 4.7 INITIAL COMMISSIONING



ATTENTION

The machine has a drip tray that can be connected to the drain hose.



ATTENTION

After completing the procedures for initial commissioning and before using the machine, the machine must be disinfected (see chapter 6.1.11 page 45).

This operation is necessary to flush the internal circuits and ensure correct preparation of the machine.

### 4.7.1 SETTING UP THE SPARKLING WATER

- Press the selector switch for sparkling water 
- Allow a few litres of water to drain until sparkling water is delivered



ATTENTION

The change in pressure only affects the carbon dioxide content after at least 2 litres of water have been drained.

## 5. USE OF THE MACHINE

### 5.1 COMMISSIONING



Ensure that all connections and settings have been made correctly. Then connect the machine to the power supply by inserting the plug into a suitable socket nearby and switch the machine on at the power switch.

Once the machine is connected and switched on, it is ready for operation.

### 5.2 SELECTION BUTTONS

14

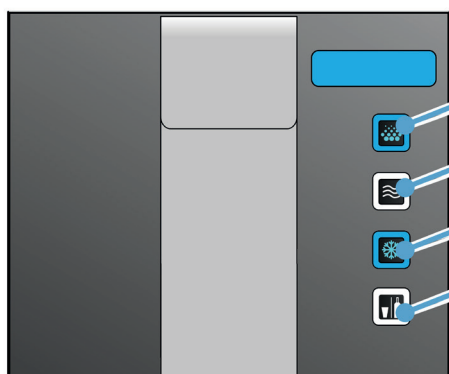

1

Quickly switch from summer to winter setting with the temperature values for summer or winter, which can be displayed but only with

2

3

„Advanced programming“

4

have to be adjusted.

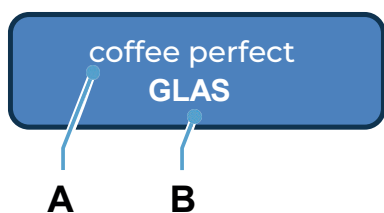

A

B

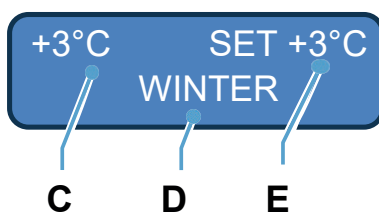

C

D

E

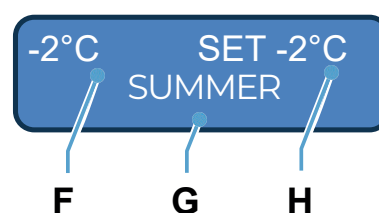

F

G

H

#### HOME SCREEN PAGES

- 1 CO<sub>2</sub> button - back
- 2 Button ambient - Next (+)
- 3 Still cooled button - Confirm
- 4 Taste Portionsgröße - Auswählen

- A Reference name
- B Dispensing type display: indicates whether the water is dispensed in the preset quantity (glass or carafe) or manually - by pressing and holding the button.
- C Temperature of the ice bank recorded with the 'Winter' setting
- D Indicates that the winter setting is selected
- E Temperature set with winter setting
- F Temperature of the ice bank recorded with the 'Summer' setting
- G Indicates that you have selected the 'Summer' setting
- H Temperature setting with the 'Summer' setting

## 5.2.1 HOW TO USE THE MACHINE

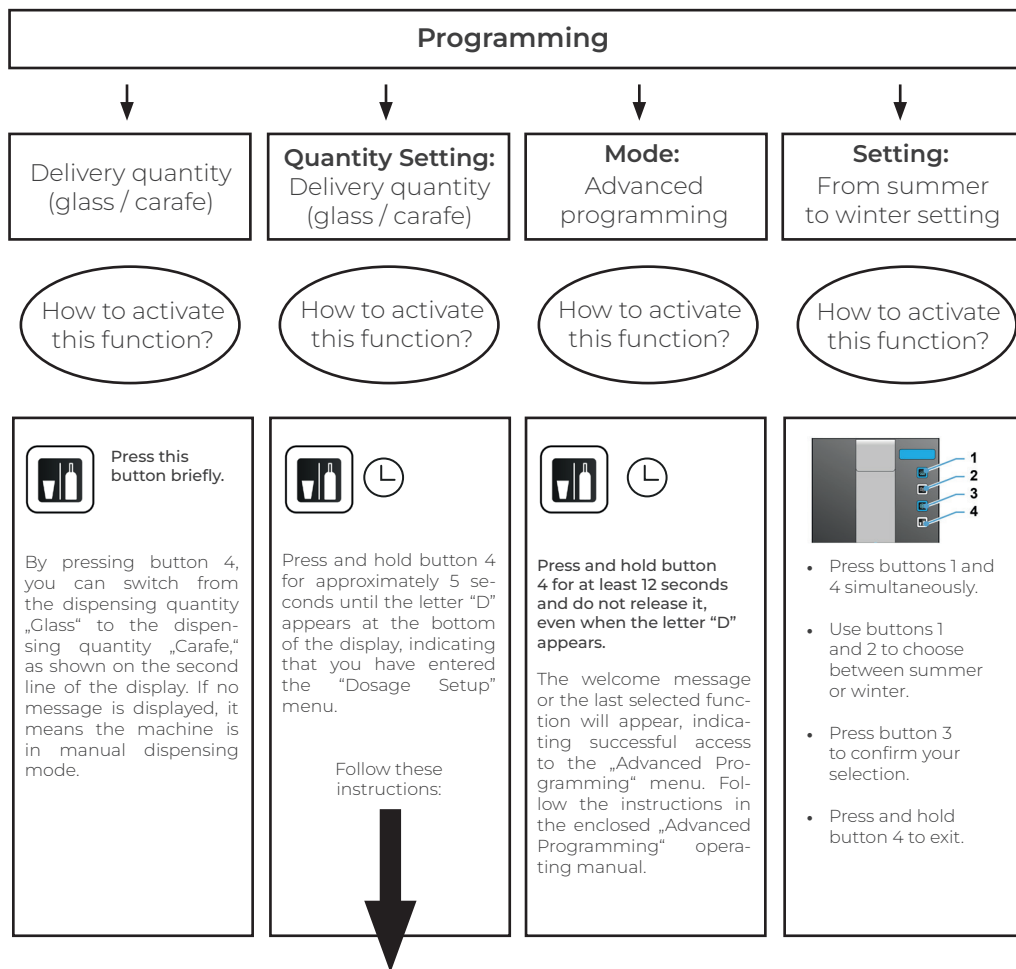



### Setting the quantity (Glass)



Pressing the button again allows you to switch between the dosing setup „glass“ and „carafe“.

Position the small water container „Glass“ at the outlet of the chilled water.



Press and hold the button for the water type to be programmed until the desired amount is reached, then press it briefly again to save.

### Setting the quantity (Carafe)



Pressing the button again allows you to switch between the dosing setup „glass“ and „carafe“.

Position the small water container „Carafe“ at the outlet of the chilled water.

Press and hold the button for the water type to be programmed until the desired amount is reached, then press it briefly again to save.

↓

The procedure for the dispensing quantity is the same for chilled, ambient, and carbonated water.

How do you return to the home screen?

The Setup Quantity menu remains active even if no operation is performed.



Press and hold the button to return to the home screen.

For each water type - chilled, ambient, carbonated - the quantity for Glass or Carafe can be set.

The display can also show the text small / large by setting the language to English or the second language German2.



To change these values, proceed as follows:

## 5.2.2 OVERVIEW OF THE ELECTRONIC FUNCTIONS

- You can easily set the water quantity depending on whether you want to fill a glass (SMALL) or a carafe (LARGE). This setting applies to ambient, chilled, or sparkling (CO<sub>2</sub>) water and ensures that the correct amount is dispensed automatically (see figs. 17 and 18)
- **Temperature setting:**
  - Summer:** lower water temperature setting, suitable for warm environments and high water demand.
  - Winter:** higher water temperature setting, suitable for cold climates and low water demand. (The machine allows you to change this setting quickly without having to enter the advanced programming mode.)
- Option to select the set temperature value for Winter (default is -3°C) (Advanced programming)
- Option to select the set temperature value for Summer (default is +2°C) (Advanced programming)
- Language setting with the option to choose between German, English, or German2 - a German language setting that uses the terms SMALL and LARGE for the quantity - for users who prefer this variant (advanced programming)
- Quickly and easily choose how the water should be dispensed: GLASS or CARAFE - preset quantities at the push of a button. Manual: Water flows only as long as you hold the button down
- You can choose how the water is dispensed: either with preset quantities - for a glass (SMALL) or a carafe (LARGE) - or in manual mode. In manual mode, the water flows only as long as you hold down the button
- Automatic cleaning: The machine automatically flushes the internal water circuit at regular intervals to prevent the formation of bacteria. A suitable drainage system is required for this. The cleaning times can be set in the „advanced programming“
- UV lamp alarm setting: This can refer to the UV lamp in the outlet area or an additional UV lamp in the water flow. Once 90% of the lamp's lifespan is reached, a blinking warning will be displayed, but water dispensing is not interrupted (advanced programming)
- Filter alarm setting: Indicates when the installed filter needs to be replaced. After 90% of its lifespan, a blinking alarm is displayed (advanced programming)
- Total and partial counting of the dispensed water volume (advanced programming)
- Operating day counter for the UV lamps, if installed (advanced programming)

## 5.3 INSTALLATION



- Open the water tap and make sure that no water leaks from unwanted areas
- Activate the main switch (7)
- Press the sparkling/carbonated water button  until all excess air has escaped from the system.
- Repeat the process with the cold water button  and the ambient water button .

---

### 5.3.1 INSTRUCTIONS FOR PREPARING SPARKLING WATER

To ensure the pump operates optimally at all times, make sure that there is always water in the machine while it is in operation.



#### NOTE

**If water from the supply network is missing, a safety system activates and the pump is blocked (the „NO WATER“ indicator light turns on). To restart the machine, the power supply must be disconnected and can only be re-connected after water flow from the supply network has been restored.**

---

The quality of carbonation depends, among other factors, on the water temperature. Therefore, after installation, wait until the water has been sufficiently cooled by the machine and the water bath is operational.

The quality of carbonation depends, among other factors, on the water temperature. Therefore, after installation, wait until the water has been sufficiently cooled by the machine and the water bath is operational.



#### ATTENTION

**After installation, a proper flow of carbonated water takes about 35-40 seconds to dispense 1 liter of water.**

---



## 5.4 TURNING OFF THE MACHINE

Do not unplug the power cord, as this will turn off the cooling system and cause the ice in the water bath to melt.



### NOTE

The deinstallation is to be carried out exclusively by the distributor's service technician.

### SHUTDOWN

If the machine will be out of service for an extended period, disconnect the power plug.

(\*) Chapter 6.1.6  
Site 43

Isolate the machine from power sources, protect it from heat and bad weather, and cover it so that it cannot be damaged by dust and/or splashes of any kind.

Close the water supply valve and the CO<sub>2</sub> bottle valve.

**If the machine needs to be shipped, stored, or moved, the water circuit must be disinfected (\*).**

**All water residues must be completely removed, as they can freeze at very low temperatures. Frozen water or disinfectant can damage internal components.**



### NOTE

If the machine has been shut down due to a malfunction, maintenance, or for any other reason, this must be indicated with an appropriate sign.

16

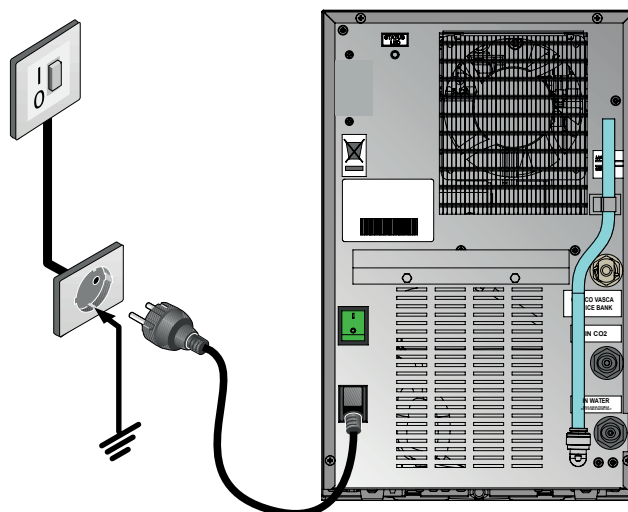

## 6. MAINTENANCE

This chapter contains a comprehensive list of the requirements and maintenance procedures for the machine in question. Proper maintenance consists of daily checks and inspections carried out directly by the operator and/or personnel trained in routine maintenance, as well as regular interventions such as cleaning, adjustments, and replacement tasks performed by authorized specialists.



**Use only original manufacturer spare parts for replacing components. If any information or procedures in this chapter are unclear, please contact your distributor.**

**If maintenance is not performed according to the included instructions, uses non-original parts, or is done without the manufacturer's written approval, or if the machine is damaged and its features impaired as a result, neither the manufacturer nor the distributor assumes any responsibility for personal safety or machine malfunctions.**

**Any unauthorized modifications will void warranty claims.**



NOTE

**No interventions, modifications, or repairs of any kind may be carried out that are not specified in this manual.**



DANGER

### POWER SUPPLY

**Before any intervention on the machine, the power supply must be disconnected to prevent injury and hazards.**

---



## 6.1 MAINTENANCE

To ensure the machine always functions properly, the maintenance tasks described below must be performed.

- 1) Cleaning the drip tray
- 2) Control of the lines

(\*) Chapter 4.6.6  
Site 31

Make sure that the water pipes, the CO<sub>2</sub> lines and the drain pipes are neither blocked nor disconnected.

- 3) Check the CO<sub>2</sub> supply and the set pressure
- 4) Make sure that the CO<sub>2</sub> bottles are full and that the correct values for CO<sub>2</sub> printing are set (\*)



**NOTE**

**Do not clean the water dispenser under a water jet that could reach the machine's electrical parts.**



**DANGER**

**Use a damp cloth to clean the machine. Do not use flammable liquids such as alcohol, benzene, or solvents. If flammable substances come into contact with the machine's electrical parts, they could cause fire or electric shock.**



**DANGER**

**For this maintenance task, as with all procedures requiring the opening of the machine housing, protective gloves must be worn to prevent the risk of cuts from the sharp edges of the metal sheets.**



### 6.1.1 CLEANING AND MAINTENANCE SCHEDULE

The following table lists the maintenance tasks to be performed at the specified intervals.

These intervals refer to normal operating conditions.

| MAINTENANCE TABLE   |                      |             |              |          |                       |              |           |
|---|----------------------|-------------|--------------|----------|-----------------------|--------------|-----------|
|   | Task to be performed |             |              |          |                       | Interval     |           |
|   | Inspection           | Replacement | Disinfection | Cleaning | At the end of the day | 3 Months     | 12 Months |
| <b>MAINTENANCE</b>  |                      |             |              |          |                       |              |           |
| Cleaning of the machine's external parts (Chapter 6.1.2, page 41)     |                      |             |              | ✓        |                       | if necessary |           |
| Replacement of the CO <sub>2</sub> cylinders (Chapter 6.1.3, page 42) |                      | ✓           |              |          |                       | if necessary |           |
| Cleaning of the aerator (Chapter 6.1.4, page 42)                      |                      |             |              | ✓        |                       | if necessary |           |
| Cleaning of the cooling condenser (Chapter 6.1.5, page 42)            |                      |             |              | ✓        |                       |              | ✓         |
| Checking the proper water connection (Chapter 6.1.6, page 43)         | ✓                    |             |              |          |                       | ✓            |           |
| Water change in the water bath (Chapter 6.1.7, page 43)               |                      | ✓           |              |          |                       | if necessary |           |
| Cleaning of the drip tray (Chapter 6.1.8, page 43)                    |                      | ✓           |              |          |                       | if necessary |           |
| Power cable (Chapter 6.1.9, page 43)                                  | ✓                    |             |              |          |                       | ✓            |           |
| Degassing (Chapter 6.1.10, page 44)                                   |                      |             |              | ✓        |                       | if necessary |           |
| Sanitation (Chapter 6.1.11, page 45)                                  |                      |             | ✓            |          |                       | if necessary |           |
| Check of the carbonator pump (Chapter 6.1.12, page 46)                | ✓                    |             |              |          |                       |              | ✓         |



### 6.1.2 CLEANING THE HOUSING

Clean the external parts of the machine with a damp cloth; do not use solvents or abrasive cleaners.



**NOTE**

**Do not clean the water dispenser under a water jet that could reach the electrical parts of the machine.**



(\*) Chapter 4  
Site 23

### 6.1.3 REPLACEMENT THE CO<sub>2</sub> CYLINDERS

If the pointer on the high-pressure gauge of the pressure reducing valve is in the red zone, the CO<sub>2</sub> cylinder must be replaced.

Follow the instructions in the „Installation“ section (\*).

After replacing the cylinder, ensure there are no leaks. CO<sub>2</sub> is a respiratory toxin with suffocating effects; it is heavier than air and tends to accumulate in enclosed spaces.

### 6.1.4 CLEANING THE AERATOR



- 1) Remove the stainless steel aerator using the appropriate wrench and remove the limescale with a food-safe descaling agent.

### 6.1.5 CLEANING THE COOLING CONDENSER

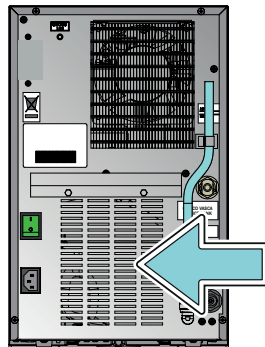

- 1) Disconnect the machine from the power supply.
- 2) Clean the condenser fins with a soft brush, vacuum cleaner, or low-pressure compressed air.
- 3) Remove any dust from the cooling system components and electrical parts.
- 4) Reconnect the machine to the power supply.



ATTENTION

**Do not use compressed air. Do not use metal brushes. Do not use high pressure, as this may cause deformation of the condenser fins.**



NOTE

**The accumulation of dust and grease on the cooling system condenser can lead to overheating, which may cause permanent damage to the compressor. The condenser must always be cleaned as needed.**



### 6.1.6 CHECKING THE WATER CONNECTION

- Check the condition and integrity of the water line
- Make sure that no water is leaking in unwanted areas



### 6.1.7 CHANGING THE WATER IN THE WATER BATH

- 1) Switch off the machine and wait approximately 1 hour for it to defrost
- 2) Drain the water using the drain hose (P)  
(see Chapter 4.6.4, page 29).
- 3) Refill the water level in the water bath as described in Chapter 4, page 23



#### NOTE

**If the machine is not used for an extended period, the water bath must be emptied.**



#### ATTENTION

**Do not reach into the open machine with your hands while it is switched on!**



### 6.1.8 CLEANING THE DRIP TRAY

Clean the tray and remove any residues that could clog the drain (if present).



### 6.1.9 POWER CABLE

Regularly disconnect the machine from the power supply and clean the plug and socket with a dry cloth.

If the machine is operated in a dusty, smoky, or very humid environment, dust accumulating on the plug may absorb moisture, compromise insulation, and potentially cause a fire.



### 6.1.10 DEGASSING

When installing the machine, or if the cooler is lacking, air bubbles can reach the interior of the carbonator.



ATTENTION

**The removal is carried out exclusively by the service technician of the sales partner.**

These air bubbles can affect the quality of carbon dioxide enrichment and should therefore be removed as far as possible.

- To do this, screw off the bottle from the pressure regulator
- Remove machine housing
- To clean the circulation, the safety valve ring (V) must be drawn (Fig. 19)
- Reconnect the CO<sub>2</sub> cylinder to the pressure reducing valve
- Let at least 2 liters of carbonated water flow out
- Assemble machine houses again (Fig. 20)



NOTE

**When the housing is remounted, make sure that the two tongues fit on the bottom of the lower part in the corresponding eyelets on the machine floor (Fig. 20).**

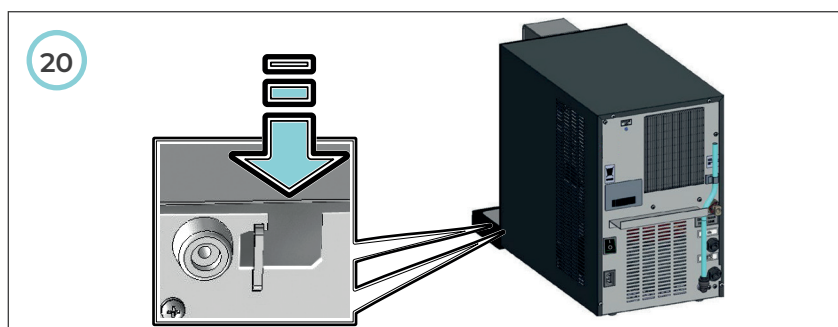
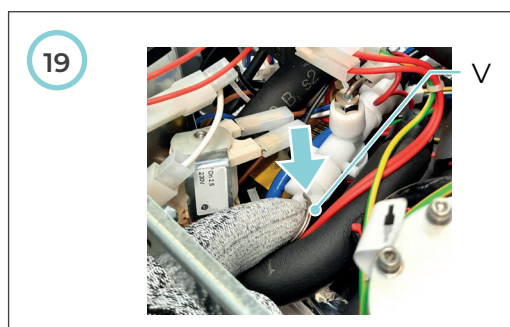
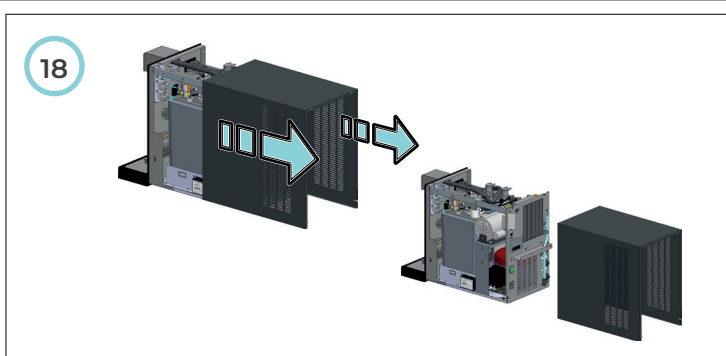



ATTENTION

For this maintenance intervention, as for all processes that require opening the machine housing, protective gloves must be worn in order to prevent the risk of cutting on the sharp edges of the sheets.

### 6.1.11 SANITATION

All installed water dispensers must be disinfected regularly, namely:



- every 12 months when used (\*)
- With every change of the water filter
- After a long standstill of the machine from one or more weeks

(\*) If the water dispenser is installed in hospitals, schools, retirement homes, clinics, etc., it is recommended to disinfect the water dispenser every 3 months.



ATTENTION

(\*) If the water dispenser is installed in hospitals, schools, retirement homes, clinics, etc., it is recommended to disinfect the water dispenser every 3 months.



ATTENTION

The products used to disinfect the parts in the water dispenser are corrosive, caustic and alkaline. Suitable disposable gloves and protective glasses must therefore be worn when handling the products. When disinfecting the water dispenser, the exposure period of the product, the concentration of the solution used and the amount of water required for rinsing must be observed.

21

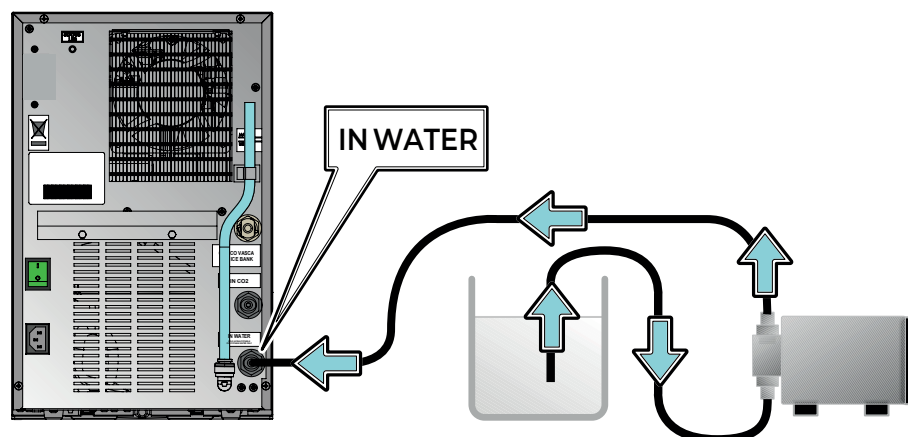



### 6.1.12 TESTING THE CARBONATOR PUMP

The inspection of the carbonator pump is to be performed exclusively by the distributor's service technician.

## 6.2 UNSCHEDULED MAINTENANCE



Unscheduled maintenance work is necessary after malfunctions or faults, which may require the replacement of certain components by authorized specialists.

If the power cable is damaged, it must be replaced by the manufacturer's technical service or qualified personnel to avoid hazards.



**NOTE**

**Only authorized specialists from the distributor may be entrusted with performing unscheduled maintenance work.**

## 7. ERROR CORRECTION



This section addresses typical error messages that may occur.

Many of these error messages are not always attributable to the refrigeration unit itself but could also be caused by the power supply or improper use of the refrigeration equipment.



| IDENTIFIED PROBLEMS  | LIKELY CAUSE  | REMEDIES  |
|--|---|---|
| <b>The compressor does not start</b>   | The power supply is interrupted                       | Check if there is voltage in the power outlet                               |
|  | The thermostat is set to OFF or is set to the minimum | Set the thermostat correctly  |
|  | The thermostat is faulty                              | Please contact the distributor  |
|  | The compressor overload protector is defective        | Please contact the distributor  |
|  | The start relay is defective                          | Please contact the distributor  |
|  | The start capacitor is defective                      | Please contact the distributor  |
|  | The compressor is defective                           | Replace the compressor  |
| <b>The drinking water is cold, but the machine is running too much or continuously</b> | The ventilation is insufficient                       | Move the machine away from the wall   |
|  | The condenser is dirty or covered                     | Please contact the distributor  |
|  | The thermostat is set to the coldest setting          | Set correctly   |
|  | The ambient temperature is higher than 32°C           | At such high temperatures, it is normal for the machine to run continuously |
| <b>The compressor runs continuously, but the water is not cold</b>                     | Refrigerant leak in the cooling system                | Contact a qualified technician (refrigeration specialist).                  |
|  | The compressor is defective                           | Replace the compressor  |
| <b>Excessive operating noise during normal machine operation</b>                       | The machine is not placed level                       | Level the machine using the adjustable feet                                 |
|  | Some pipes are touching parts inside the machine      | Route the pipes or hoses so that they do not touch any internal parts       |

| IDENTIFIED PROBLEMS   | LIKELY CAUSE  | REMEDIES  |
|---|---|---|
| <b>The water flow (chilled, ambient) is too weak or no water is being dispensed</b>               | The inlet pressure is too low   | Have the pressure increased   |
|   | Solenoid valve defective  | Replace it  |
|   | Water filter clogged  | Replace it  |
|   | The defective temperature controller causes complete freezing of the ice display cabinet.<br>Remedy: Check the temperature controller and replace it if necessary | Let the ice melt. Replace the temperature controller                            |
| <b>The carbonated water has too little or no carbonation</b>                                      | The carbon dioxide pressure on the CO <sub>2</sub> pressure reducer is set to a value below 3 bar   | Increase pressure up to 3.5 – 4 bar   |
|   | CO <sub>2</sub> cylinder empty  | Replace it  |
|   | The outlet water temperature is too high  | Set the thermostat to maximum power   |
|   | Air bubbles in the carbon dioxide evaporator  | Release the air   |
| <b>Only carbon dioxide (CO<sub>2</sub>) is coming out of the sparkling water dispenser nozzle</b> | The level probes are contaminated   | Check and replace   |
|   | The pump runs continuously  | No water is flowing in, or the water filter is clogged                          |
|   | The pump runs continuously, although there is water at the water inlet  | The connection at the inlet of the carbonator is clogged. Disassemble and clean |
|   | The pump is blocked or the pump motor is not running  | Check and replace if necessary  |
|   | The level controller is defective   | Check and replace   |
|   | The pump safety switch has been triggered (no water)  | Disconnect the power supply and reconnect the machine to perform a reset        |
| <b>The dispenser nozzles are dripping</b>   | Solenoid valve contaminated   | Remove and clean the solenoid valve   |
| <b>Instead of still water, sparkling water is being dispensed</b>                                 | The shut-off valve at the inlet of the carbonator is contaminated   | Remove and clean or replace   |

**For other causes not listed in this manual, please contact customer service.**

7.1 ERROR MESSAGES

| IDENTIFIED PROBLEMS   | LIKELY CAUSE   | REMEDIES   |
|---|--|--|
| <p><b>+10 °C    SET-03 °C</b><br/><b>NO WATER</b></p>       | <p>For the ACWG models, if the carbonator pump runs continuously for more than 4 minutes, it is stopped by a safety system and simultaneously the solenoid valve for CO<sub>2</sub> enrichment is inhibited</p>                              | <p><b>CHECK:</b></p> <ul style="list-style-type: none"> <li>- the presence of tap water</li> <li>- the correct connection of the pipes to the water supply,</li> <li>- the presence of a clogged filter</li> <li>- that the level probe of the carbonator pump is connected,</li> <li>- that the ice bank is not frozen.</li> <li>- that the pump is not stopped or blocked.</li> </ul> <p>As long as the problem is not resolved, no carbonated water can be dispensed.</p> <p>After the cause has been resolved, the machine must be turned off and then turned back on.</p> |
| <p><b>-----    SET-03 °C</b><br/><b>SENSOR ALARM</b></p>    | <p>Activates if the temperature sensor is defective and the following conditions are not met:</p> <ol style="list-style-type: none"> <li>1) a correct temperature measurement</li> <li>2) a correct control of the cooling cycles</li> </ol> | <p><b>CHECK:</b></p> <ul style="list-style-type: none"> <li>- check the electrical continuity of the temperature sensor using a tester.</li> <li>- The correct electrical connections of the temperature sensor.</li> </ul> <p>As long as the problem is not resolved, no CO<sub>2</sub> containing or still cold water can be dispensed, and the compressor function is also blocked.</p> <p>After the cause has been resolved, the machine must be turned off and then turned on again.</p>  |
| <p><b>+10 °C    SET-03 °C</b><br/><b>ALARM UV LAMP</b></p>  | <p>Message indicating that the UV lamp, if installed, is depleted. It starts blinking as soon as 90% of the lamp's preset lifespan has been used up</p>  | <ul style="list-style-type: none"> <li>- Replace the UV lamp and reset the hour counter by accessing the „Advanced Programming“ menu.</li> </ul> <p>The lamp alarm does not stop the water outlet.</p>   |
| <p><b>+10 °C    SET-03 °C</b><br/><b>REPLACE FILTER</b></p> | <p>Message indicating that a filter, if installed, is depleted. It starts blinking when 90% of the filter's preset total capacity has been reached</p>   | <ul style="list-style-type: none"> <li>- Replace the filter and reset the partial liter count by entering „Advanced Programming.“</li> </ul> <p>The filter alarm does not stop the water flow.</p>   |

| IDENTIFIED PROBLEMS   | LIKELY CAUSE  | REMEDIES   |
|---|---|--|
|  | <p>Out-of-range alarm</p> <p>If the temperature detected by the probe is outside the acceptable range, dashes appear on the left side of the display. The water in the ice bank is likely too hot or too cold (in which case, the ice bank could freeze).</p> | <p>If the temperature is too high, wait the time necessary for the ice bank to form. If the temperature is too low, the ice bank is probably frozen. Therefore, turn off the machine and wait a few hours before restarting it. Then adjust the temperature again.</p> <p>If the problem persists, contact customer service.</p> |
|  | <p>Intervenes when one or more outlet solenoid valves are open but the selected water does not come out and consequently the corresponding flow meter does not rotate.</p>  | <p><b>CHECK:</b></p> <p>The presence of tap water</p> <p>The correct connection of the pipes to the water supply, the presence of a clogged filter, and that the water in the ice bank is not frozen.</p> <p>After eliminating the cause, the machine will start automatically.</p>  |

FOR OTHER CAUSES NOT LISTED IN THIS MANUAL, CONTACT THE CUSTOMER SERVICE CENTER

## 7.2 ADVANCED PROGRAMMING

This section is reserved exclusively for qualified operators.



12 sek

How to access the Advanced Programming menu:

Hold the button down for at least 12 seconds.



How to return to the home screen page:

Press this button or do not press any button for at least 30 seconds to return to the home screen during any programming phase.

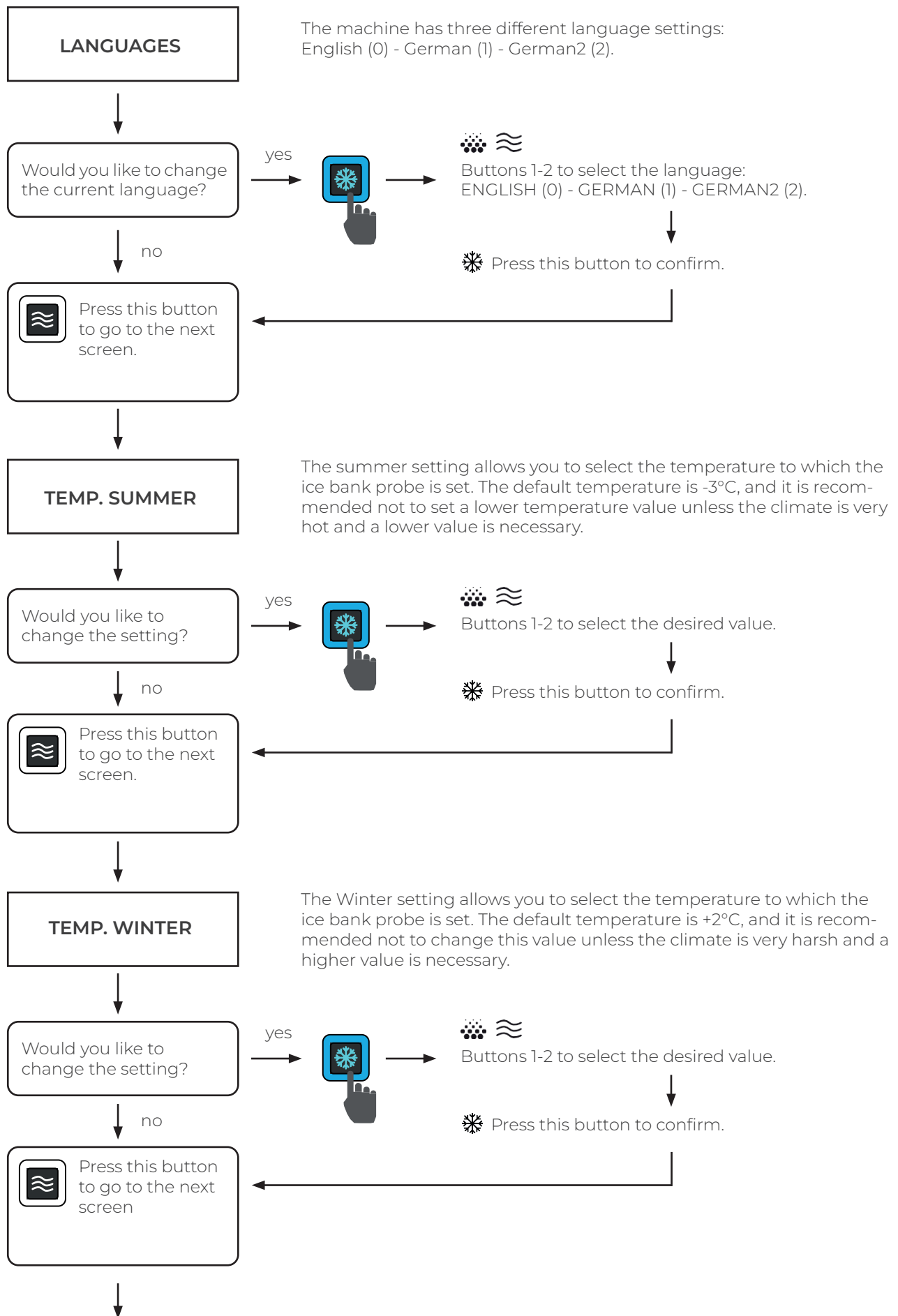

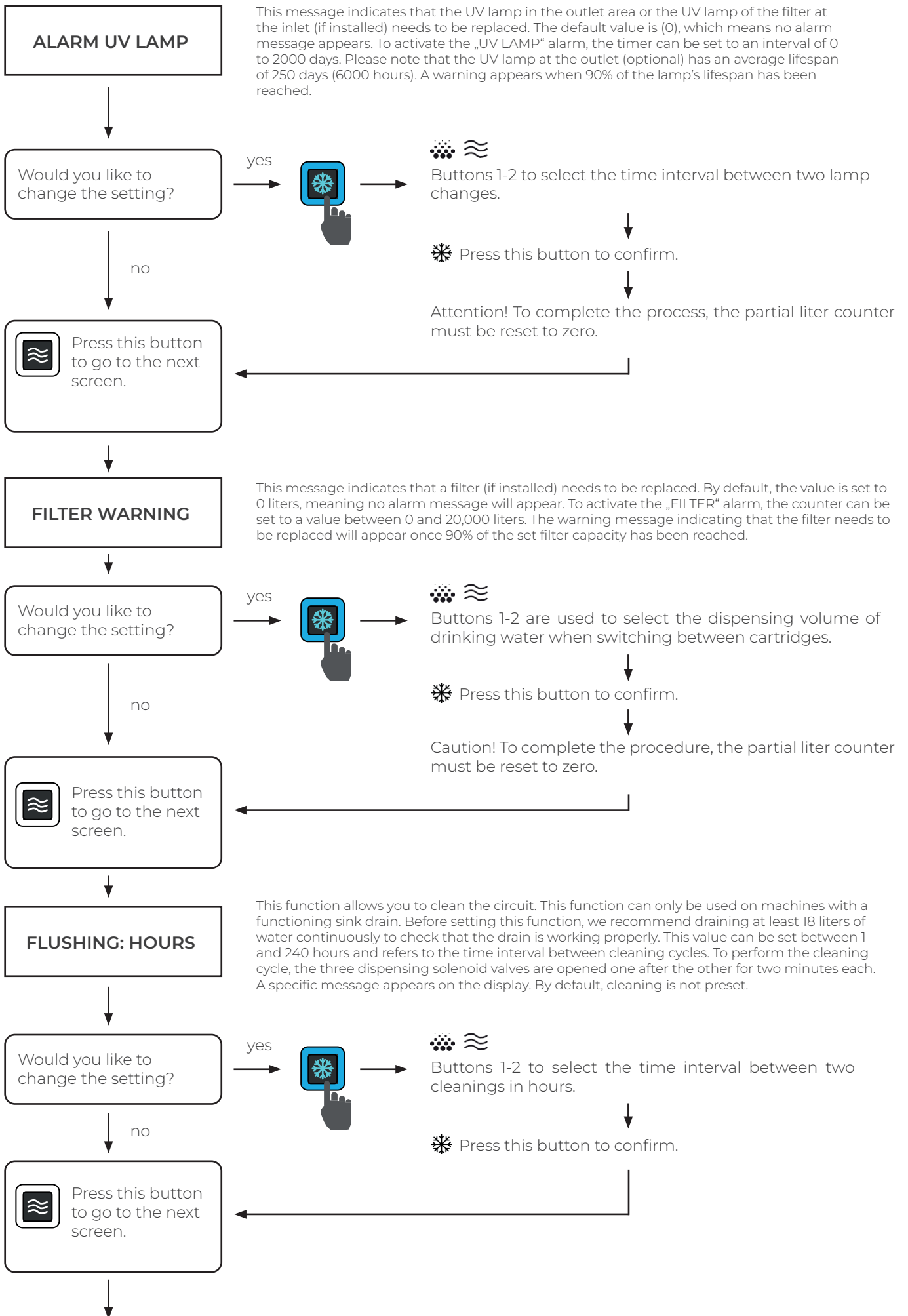

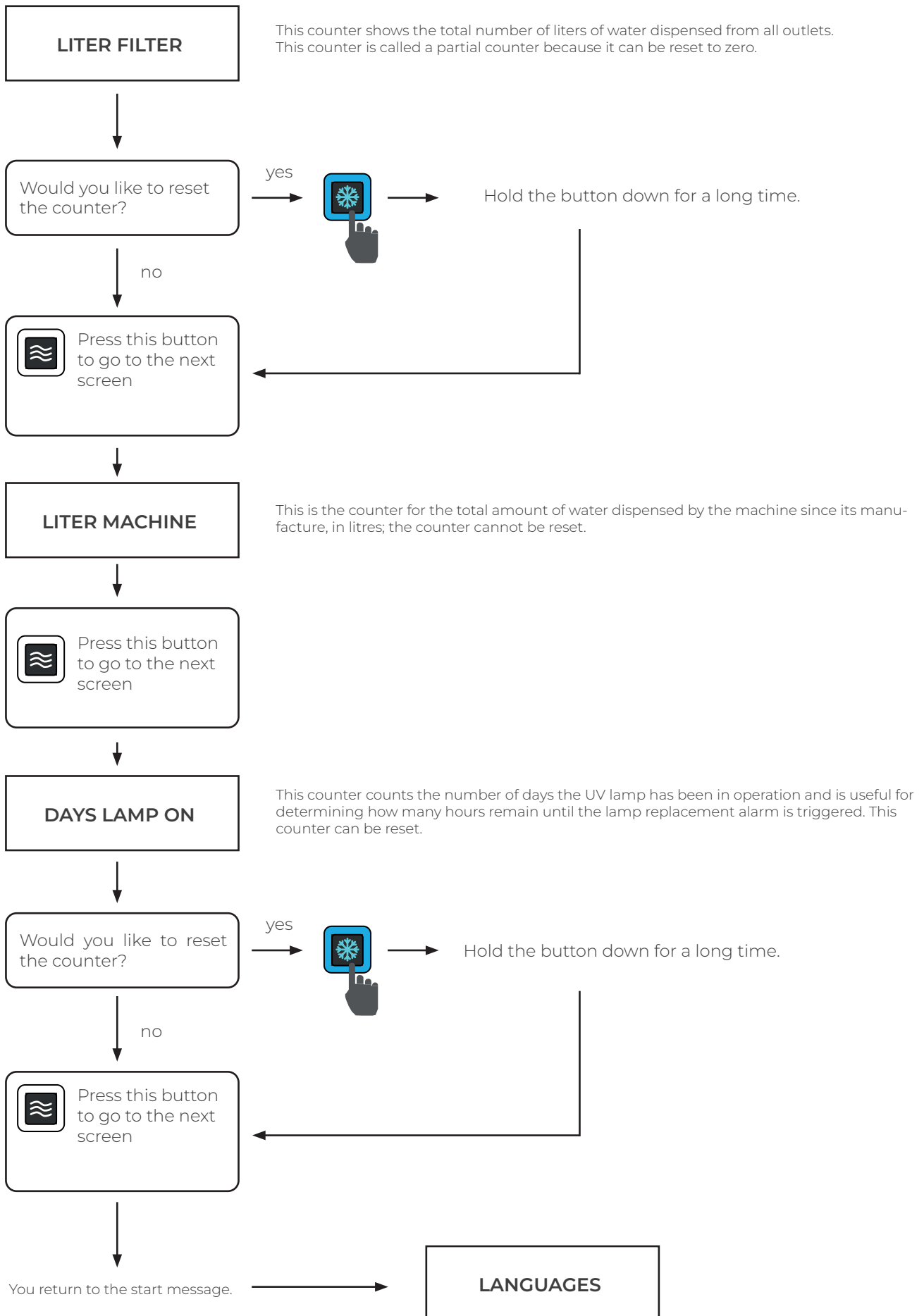

## 8. FURTHER INSTRUCTIONS

### 8.1 DISPOSAL

It should be remembered that industrial waste materials that cannot be disposed of as household waste due to their quality or quantity are to be treated as hazardous waste.

Defective or outdated machines are also considered hazardous waste.

In accordance with the local legal provisions, the user must take certain precautions regarding the disposal of the materials, such as:

- Material of the accompaniment (PVC and methacrylate)
- Plastic of pneumatic hoses
- Sheathed electrical cables
- Rubber strap
- Waste oil
- Refrigerant gas R290 (HFC)

### 8.2 UNINSTALLATION



#### NOTE

**The processes of disassembly and disassembly must be carried out by qualified staff.**

The machine has to be dismantled after dismantling the various components and after the gas is collected, the R290 type.

In the processes of the disassembly, wear the individual protective devices listed in the manual and note the instructions and technical drawings contained in this manual, or if necessary, contact the manufacturer for specific information.

All cooling gases, CFC, H-FCKW and FKW, must not be released, but must be collected for disposal or reprocessing, since they represent special waste and danger waste (marked with the code 140601\*).

These gases must be handed over to the facilities approved for the disposal of these products. After the different parts have been dismantled, the components are to be split up, whereby metal of plastic, copper etc. depending on the applicable procedure for the waste separation of the country in which the machine is broken down can be separated.

Waste that arises during disassembly of the machine can be classified as hazardous waste.

If the various components have to be stored to a waste collection point before a transfer, they must be kept in a safe and weather-protected place to avoid that soil and groundwater are contaminated.

In any case, the local provisions for waste disposal must be observed.



### 8.3 DISPOSAL OF ELECTRONIC COMPONENTS (WEEE-DIRECTIVE)

The European Directive 2002/96/EC (RAEE) specifies a number of obligations for producers and users of electrical and electronic machines with regard to the collection, treatment, recycling and disposal of these waste.

It is strongly recommended to strictly adhere to these standards for the disposal of these waste. It is also remembered that illegal disposal of these waste leads to the administrative penalties provided for by the applicable standards.

**coffee perfect GmbH | Germany**

Register at our Solution Center - free of charge at: +49 (0) 541 76013 - 0

Fax: +49 (0) 541 76013 - 499

Netter Platz 1, 49090 Osnabrück

info@coffee-perfect.de - www.coffee-perfect.de

**coffee perfect | Austria is a member of CP Austria GmbH**

Register at our Solution Center - free of charge at: +43 (0) 512 214 - 081

Fax: +43 (0) 512 214 - 082

Grabenweg 67 b, 6020 Innsbruck

info@coffee-perfect.at - www.coffee-perfect.at

**coffee perfect | Denmark is a member of CP Denmark A/S**

Please contact us for free: +45 787 93 108

Fax: +45 787 93 144

Birk Centerpark 40, 7400 Herning

info@coffee-perfect.dk - www.coffee-perfect.dk